

ATTENTION:

FIXTURE INSTALLATION MUST BE DONE BY LICENSED ELECTRICIAN.
SHUT OFF POWER SUPPLY AT FUSE OR CIRCUIT BREAKER.
USE ONLY THE SPECIFIED BULBS AND DO NOT EXCEED THE MAXIMUM WATTAGE.

BEFORE YOU INSTALL:

1. Check the fixture frame for any physical damage
2. Check all parts to ensure they are not damaged or missing
3. Test all sockets with a bulb for conductivity before "dressing" the fixture
4. If there is any problem, please do not install the fixture, please contact the vendor and solve the problem first.

- A. Bracket
- B. Support screws
- C. Wire nuts
- D. Screw
- E. Canopy
- F. Iron tubes
- G. Circular tube ring
- H. Load-bearing screw
- I. Glass shade

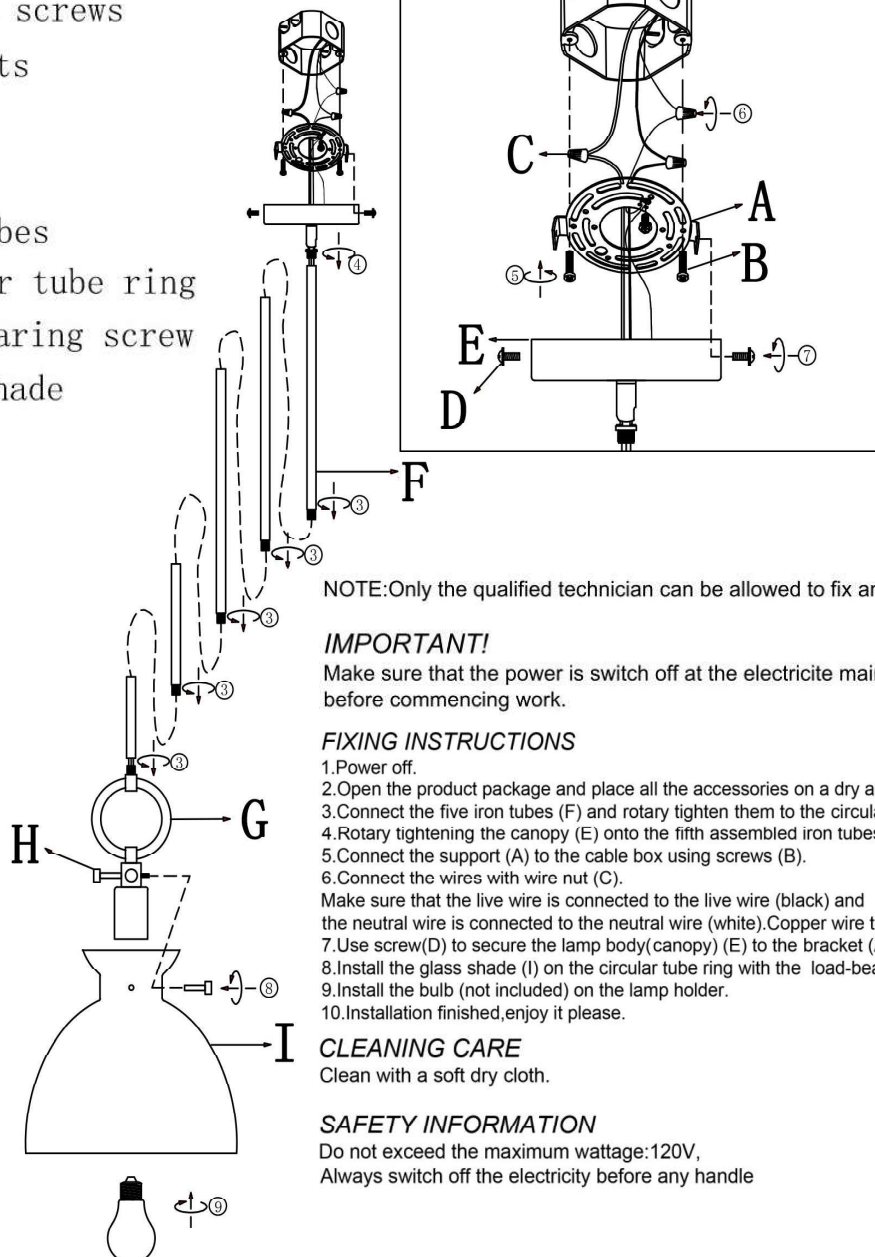

NOTE: Only the qualified technician can be allowed to fix and maintain.

IMPORTANT!

Make sure that the power is switch off at the electricite mains supply before commencing work.

FIXING INSTRUCTIONS

1. Power off.
2. Open the product package and place all the accessories on a dry and safe ground.
3. Connect the five iron tubes (F) and rotary tighten them to the circular tube ring (G).
4. Rotary tightening the canopy (E) onto the fifth assembled iron tubes (F).
5. Connect the support (A) to the cable box using screws (B).
6. Connect the wires with wire nut (C).
- Make sure that the live wire is connected to the live wire (black) and the neutral wire is connected to the neutral wire (white). Copper wire to ground (GDN).
7. Use screw (D) to secure the lamp body (canopy) (E) to the bracket (A).
8. Install the glass shade (I) on the circular tube ring with the load-bearing screw (H).
9. Install the bulb (not included) on the lamp holder.
10. Installation finished, enjoy it please.

CLEANING CARE

Clean with a soft dry cloth.

SAFETY INFORMATION

Do not exceed the maximum wattage: 120V,
Always switch off the electricity before any handle